

CALL FOR OFFERS UNIQUE BEACH FRONT PROPERTY ±219 ACRES FOR SALE

GALVESTON, TEXAS



**OFFERS DUE
JULY 29, 2013**



Spectacular beach front property now available. Site is located on far west end of Galveston Island, fronting the Gulf of Mexico & Bluewater Highway. Approximately 60 miles from Houston CBD.

List Price: Call For Offers
Utilities: City of Galveston utilities to site

Due Diligence Package will be Available

*Properly authorized Buyer's Broker Fee Available

FOR MORE INFORMATION CONTACT:

Bill McDade
713.577.1876
bill.mcdade@cbre.com

Peter Mainguy
713.577.1782
peter.mainguy@cbre.com

Kristen McDade
713.577.1808
kristen.mcdade@cbre.com

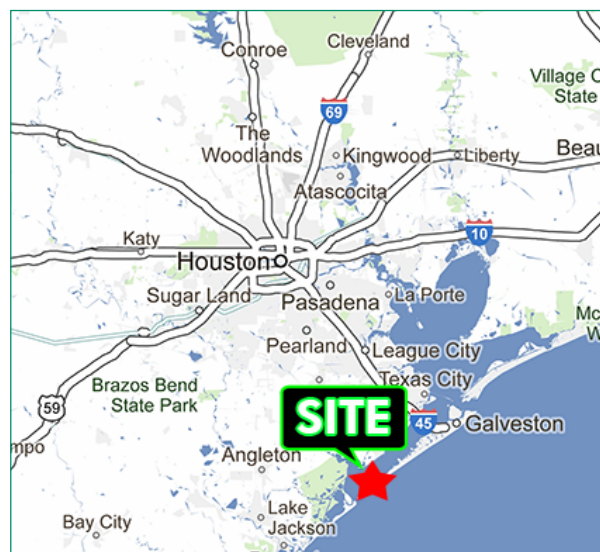

CALL FOR OFFERS UNIQUE BEACH FRONT PROPERTY ±219 ACRES FOR SALE

GALVESTON, TEXAS

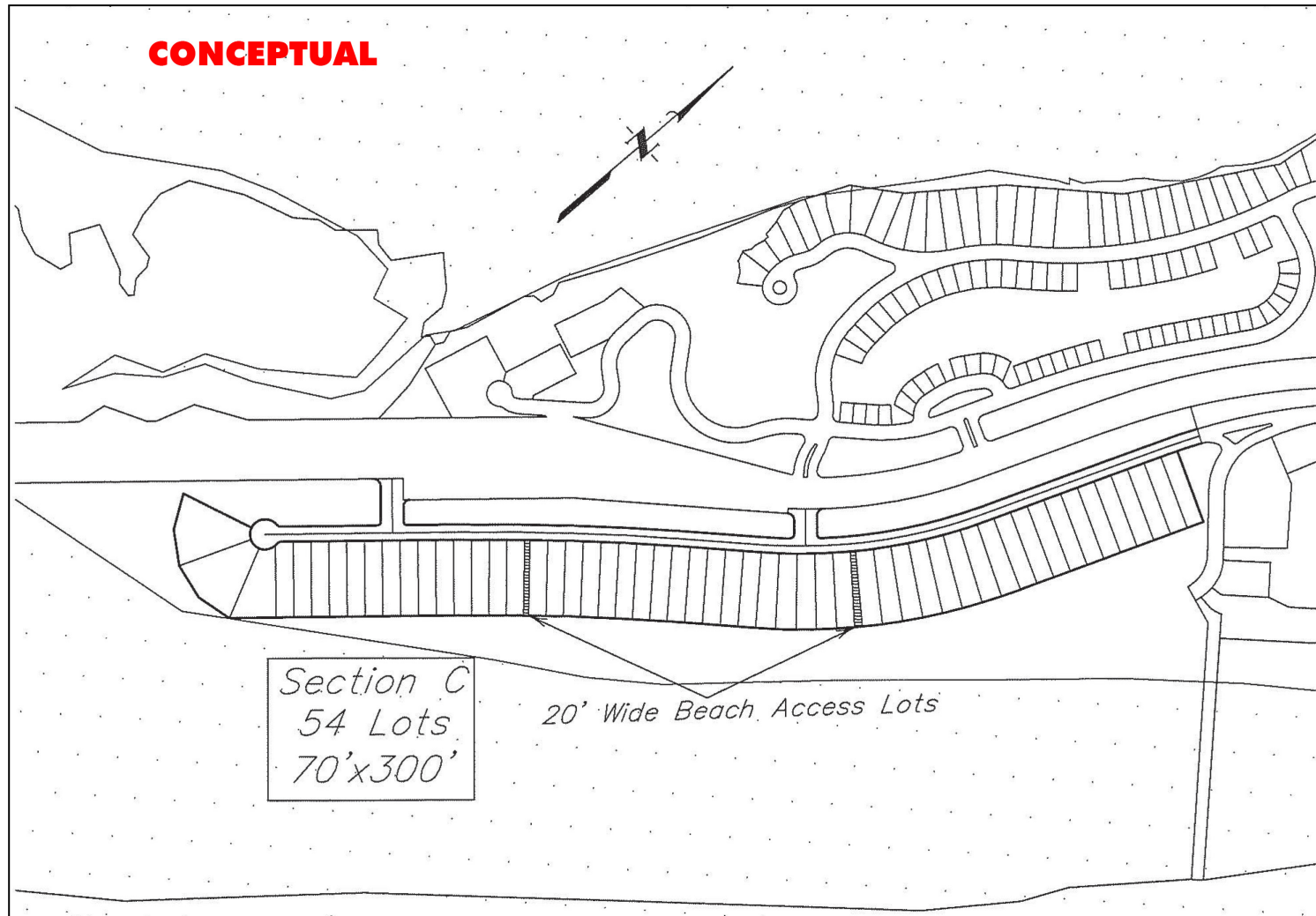

Bill McDade
713.577.1876
bill.mcdade@cbre.com

Peter Mainguy
713.577.1782
peter.mainguy@cbre.com

Kristen McDade
713.577.1808
kristen.mcdade@cbre.com

CBRE

CALL FOR OFFERS UNIQUE BEACH FRONT PROPERTY ±219 ACRES FOR SALE

GALVESTON, TEXAS

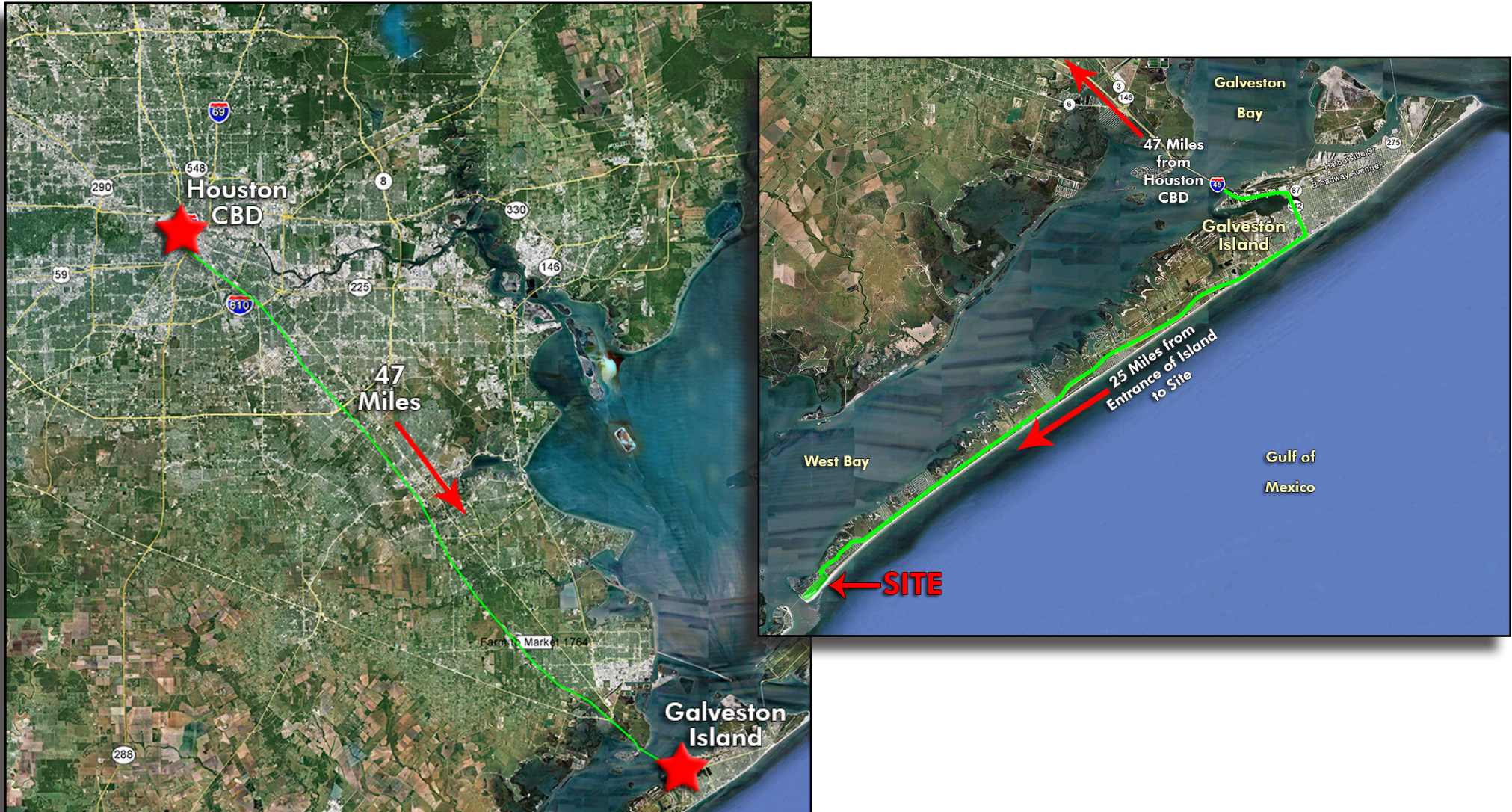

Bill McDade
713.577.1876
bill.mcdade@cbre.com

Peter Mainguy
713.577.1782
peter.mainguy@cbre.com

Kristen McDade
713.577.1808
kristen.mcdade@cbre.com

CBRE

CALL FOR OFFERS UNIQUE BEACH FRONT PROPERTY ±219 ACRES FOR SALE

GALVESTON, TEXAS

Galveston Island Economy

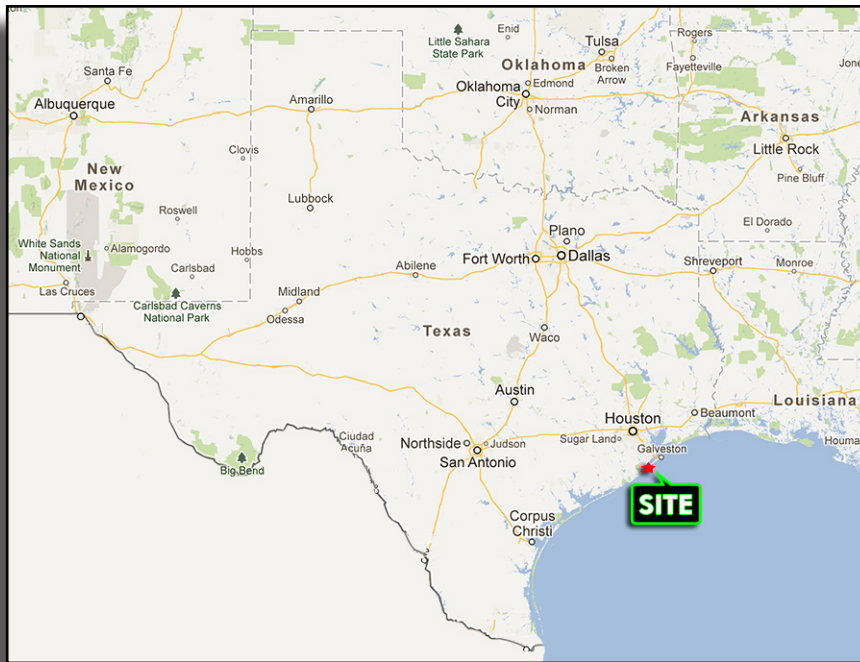

Being just 60 miles south of Houston's CBD, Galveston benefits due to its close proximity to the 4th largest city in the country, while maintaining its small town feel and charm. Maritime and offshore oil and gas exploration, healthcare and education, and tourism serve as the cornerstones of Galveston's economic base.

- **Maritime Related Fields and Support Services for the Offshore Oil and Gas Industry**
The 4th largest city in the country, and growing, Houston's growth is in part due to its activity in the oil, gas and petrochemical related industries. The Houston area produces 26% of the country's gasoline. Galveston is a major entry way to Houston from the Gulf of Mexico. Galveston's deepwater port, along with its location, makes it an important hub for businesses that support the offshore oil and gas industry. In addition to serving the oil industry, it is a shipping center for other cargo and ranks as the 6th busiest cruise port in the United States, generating \$1.1 billion in direct spending in Texas.
- **Medical Research, Healthcare and Education**
The University of Texas Medical Branch at Galveston is the Island's largest employer, making Galveston a center for state of the art research health care facilities. Galveston is also home to two other institutions of higher education - Texas A&M University at Galveston (TAMUG) and Galveston College.
- **Hospitality and Tourism**
With its 32 miles of beach along the gulf coast, Galveston Island is a top tourist destination for the region. Galveston attracts approximately 6 million visitors a year, generating an estimated \$800 million infusion. The beaches are not the only thing that attracts visitors, but also the Island's parks, cultural and historical sites and the 180 special events hosted annually.

Bill McDade
713.577.1876
bill.mcdade@cbre.com

Peter Mainguy
713.577.1782
peter.mainguy@cbre.com

Kristen McDade
713.577.1808
kristen.mcdade@cbre.com

CBRE

CALL FOR OFFERS UNIQUE BEACH FRONT PROPERTY ±219 ACRES FOR SALE

GALVESTON, TEXAS

Houston's Robust Economy and Leading Job Growth

The Houston metro area continues to set the pace for job growth in the nation, recording a 4.5 percent increase in employment from February '12 to February '13, according to data released by the U.S. Bureau of Labor Statistics (BLS). That's three times the pace of job growth for the nation as a whole and faster than any other major metro.

The Galveston region is included in the Houston - Sugar Land - Baytown Metropolitan Statistical Area (Houston MSA). This region consists of 10 counties. Houston added 118,700 net jobs during the 12 months ending February '12.

Since January '10, the month the recession ended here, Houston has created 276,900 new jobs, 180.9 percent of what the region lost. At the current pace of growth, Houston area employment will top 2.8 million before the end of the year.

(Counties within the Houston metro area: Harris, Fort Bend, Montgomery, Brazoria, Galveston, Liberty, Waller, Chambers, and Austin)
Source: *Houston Economy at a Glance*

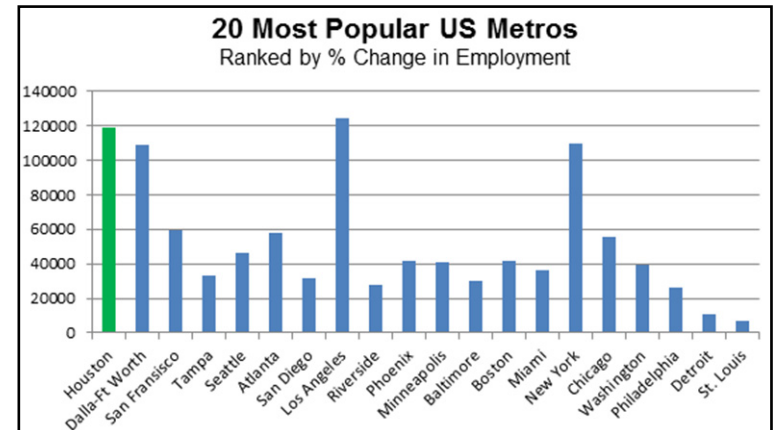
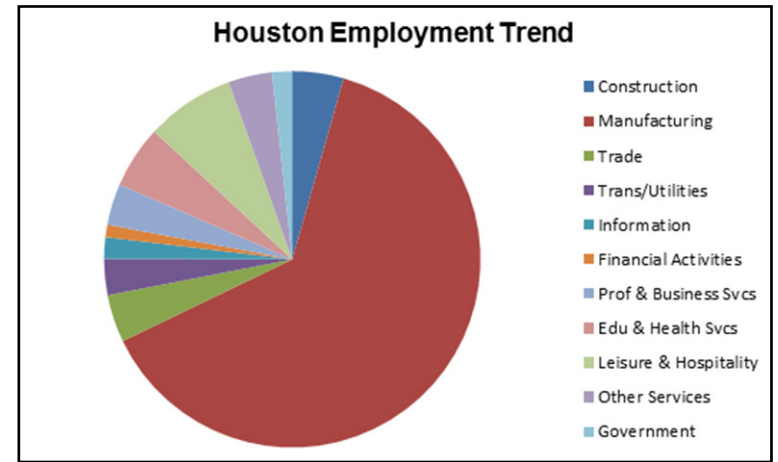

Bill McDade
713.577.1876
bill.mcdade@cbre.com

Peter Mainguy
713.577.1782
peter.mainguy@cbre.com

Kristen McDade
713.577.1808
kristen.mcdade@cbre.com

